

DigiTech

FEATURES

KEYPAD

- 16x2 Display
- 10 alphanumeric keys
- Function keys
- Keypad test
- Automatic DST
- Green/Red Led
- Buzzer
- Battery compartment
- Dallas key reader
- Power
 - 9V alkaline battery
 - battery box
 - power supply

Not all the features are available in the standard configuration. Please remember to request the desired functions.



LOCKS

SwingBolt



DeadBolt



LatchBolt



Motor LatchBolt Lock



MotorLock



MotorLock Push&Pull



- Manager
- 28 Users
- Override user
- Time delay 1-99 minutes
- Open window 1-19 minutes
- Audit trail with time and date 8.000 events
- Silent alarm and Remote disable opening
 - or Remote time delay override
- Penalty
- Dallas key management
- Dual mode



DigiTech Keypad

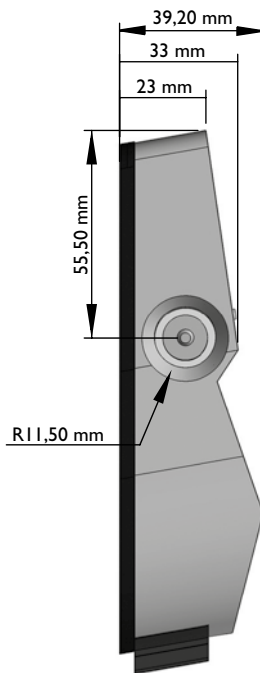
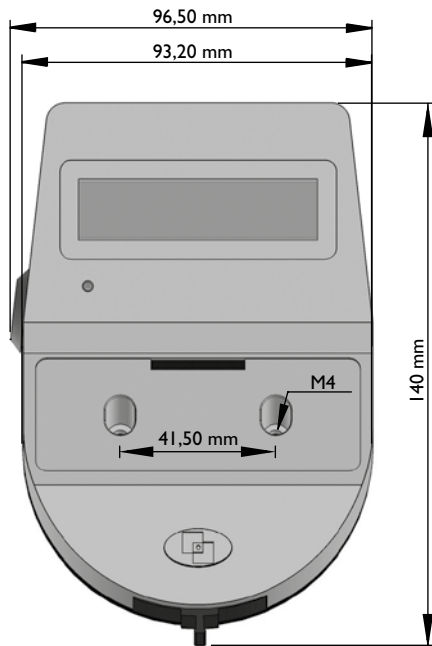

SwingBolt

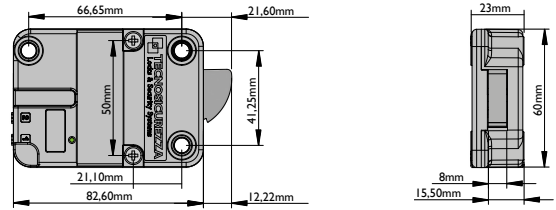

DeadBolt

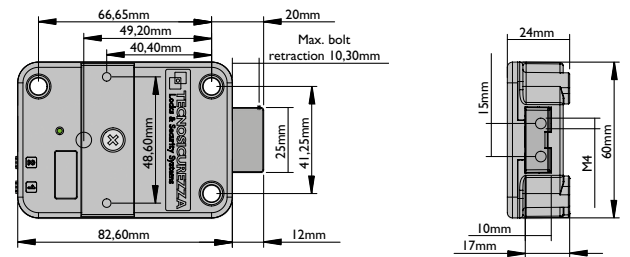

LatchBolt

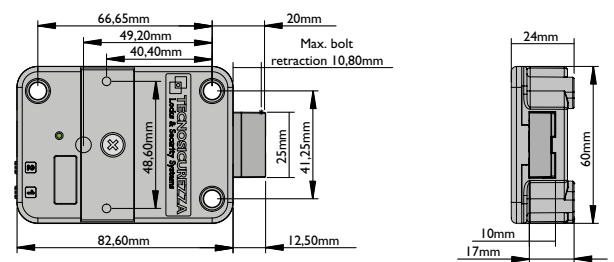

MotorLock/MotorLock Push&Pull

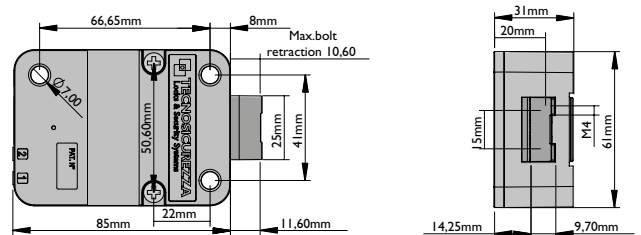

Motor LatchBolt Lock

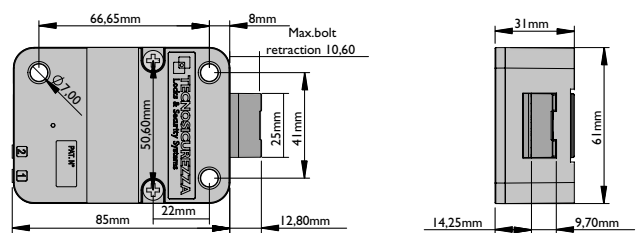

v. 2.1-22

GLOBAL HEADQUARTERS

Tecnosicurezza SpA
Via C. Battisti, 276
37057 S.Giovanni Lup.(VR)
ITALY
info@tecnosicurezza.it
www.tecnosicurezza.it

USA HEADQUARTERS

Tecnosicurezza Inc
60, Thomas Lane
Versailles, KY 40383
USA
info@usatecno.com
www.usatecno.com

SPAIN HEADQUARTERS

Tecnosicurezza SA
C/Menor, 4 - Nave 10, Pol Ind. "La Mina"
28770 Colmenar Viejo
SPAIN
info@tecnosicurezza.es
www.tecnosicurezza.es